

Soils Map

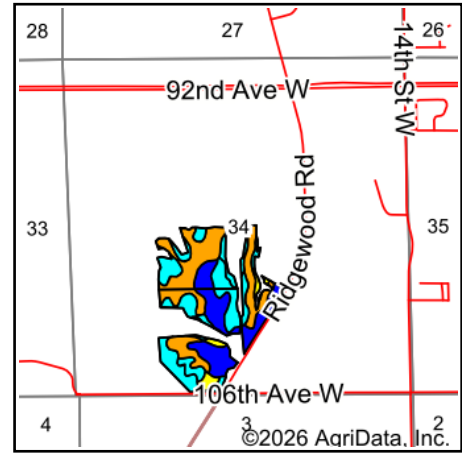

State: **Illinois**
 County: **Rock Island**
 Location: **34-17N-2W**
 Township: **Blackhawk**
 Acres: **66.21**
 Date: **5/26/2026**

©2026 AgriData, Inc.

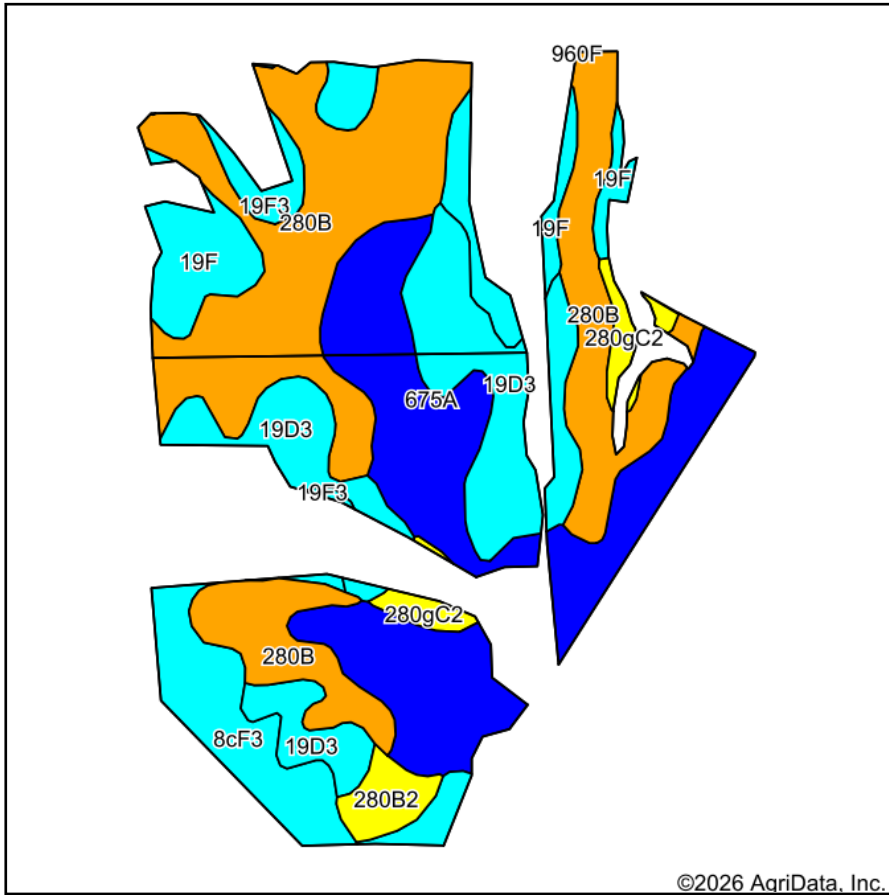

Soils data provided by USDA and NRCS.

Area Symbol: IL161, Soil Area Version: 21

Code	Soil Description	Acres	Percent of field	Il. State Productivity Index Legend	Restrictive Layer	Soil Drainage	*Subsoil rooting a	*Corn Bu/A	*Soybeans Bu/A	*Wheat Bu/A	*Oats Bu/A b	*Grass-legume hay, T/A	*Crop productivity index for optimum management	*n NCCPI Overall
**280B	Fayette silt loam, glaciated, 2 to 5 percent slopes	22.86	34.6%		> 6.5ft.	Well drained	FAV	**164	**52	**65	**83	**5.00	**120	89
675A	Greenbush silt loam, 0 to 2 percent slopes	16.76	25.3%		> 6.5ft.	Well drained	FAV	184	58	70	97	5.00	134	90
**19D3	Sylvan silty clay loam, 10 to 18 percent slopes, severely eroded	11.39	17.2%		> 6.5ft.	Well drained	FAV	**118	**38	**47	**55	**3.00	**87	68
**19F	Sylvan silt loam, 18 to 35 percent slopes	5.23	7.9%		> 6.5ft.	Well drained	FAV	**109	**35	**43	**50	**3.00	**80	20

Code	Soil Description	Acres	Percent of field	Il. State Productivity Index Legend	Restrictive Layer	Soil Drainage	*Subsoil rooting a	*Corn Bu/A	*Soybeans Bu/A	*Wheat Bu/A	*Oats Bu/A b	*Grass-legume e hay, T/A	*Crop productivity index for optimum management	*n NCCPI Overall
**8cF3	Hickory clay loam, cool mesic, 18 to 35 percent slopes, severely eroded	4.63	7.0%		> 6.5ft.	Well drained	FAV	**72	**24	**29	**33	**2.00	**55	17
**19F3	Sylvan silty clay loam, 18 to 35 percent slopes, severely eroded	1.87	2.8%		> 6.5ft.	Well drained	FAV	**90	**29	**36	**42	**2.00	**66	18
**280gC2	Fayette silt loam, glaciated, 5 to 10 percent slopes, eroded	1.40	2.1%		> 6.5ft.	Well drained	FAV	**155	**49	**61	**79	**5.00	**113	84
**280B2	Fayette silt loam, glaciated, 2 to 5 percent slopes, eroded	1.35	2.0%		> 6.5ft.	Well drained	FAV	**157	**50	**62	**80	**5.00	**115	85
**960F	Hickory-Sylvan-Fayette silt loams, 18 to 30 percent slopes	0.72	1.1%		> 6.5ft.	Well drained	FAV	**104	**34	**41	**49	**3.00	**77	20
Weighted Average								147.3	46.9	57.7	74	4.2	107.9	*n 72.2

Table: Optimum Crop Productivity Ratings for Illinois Soil EFOTG are sourced from Bulletin 811 calculated Map Unit Base Yield Indices, and adjusted (Adj) for slope, erosion, and surface texture. Publication Date: 02-08-2023

Crop yields and productivity (B811 EFOTG) are maintained at the following USDA web site: 2023 Illinois Soil Productivity and Yield Indices: <https://efotg.sc.egov.usda.gov/#/state/IL/documents/section=2&folder=52809>

* The flood/pond factor has been removed for B811 indexes and yields.

** Base indexes from Bulletin 811 adjusted for slope, erosion, and surface texture according to the Il. Soils EFOTG

b Soils in the southern region were not rated for oats and are shown with a zero "0".

e Soils in the well drained group were not rated for grass-legume and are shown with a zero "0".

*n: The aggregation method is "Weighted Average using all components"