

Soils Map

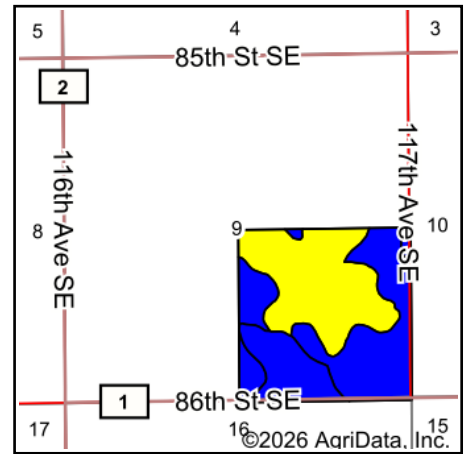

State: **North Dakota**
 County: **Sargent**
 Location: **9-131N-58W**
 Township: **Verner**
 Acres: **159.85**
 Date: **1/24/2026**

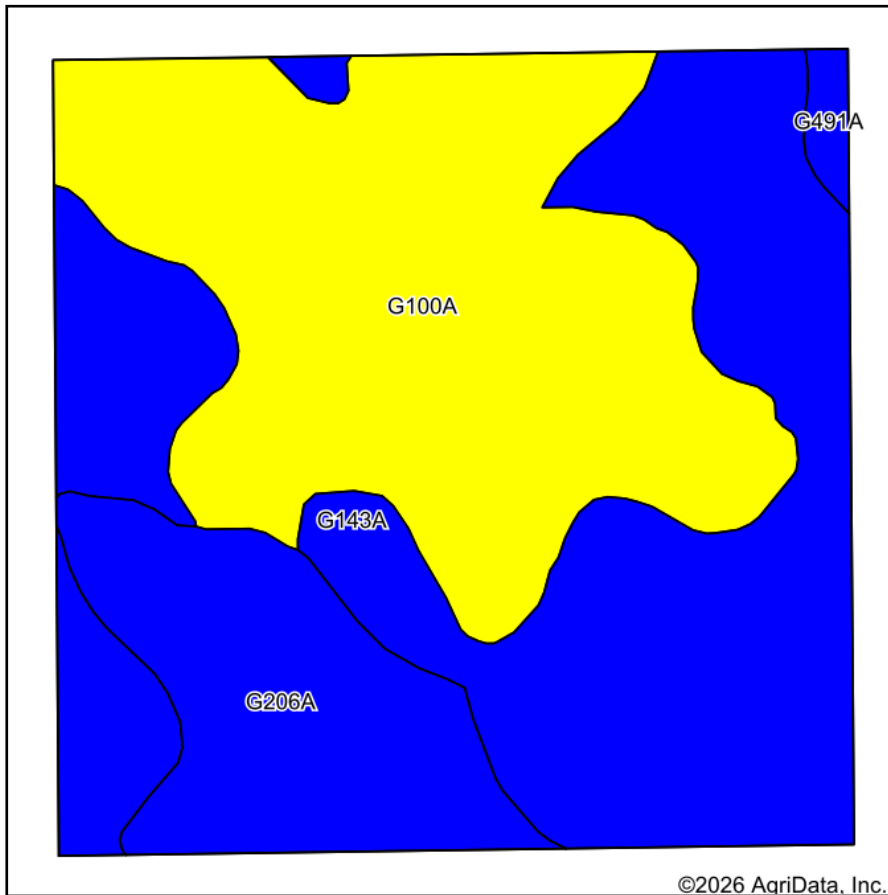



HAYDEN  OUTDOORS.

Maps Provided By:

 CUSTOMIZED ONLINE MAPPING
 © AgriData, Inc. 2025 www.AgriDataInc.com



Area Symbol: ND081, Soil Area Version: 33

Code	Soil Description	Acres	Percent of field	PI Legend	Restrictive Layer	Soil Drainage	Non-Irr Class *c	Range Production (lbs/acre/yr)	Productivity Index	*n NCCPI Overall
G143A	Barnes-Svea loams, 0 to 3 percent slopes	67.23	42.1%		> 6.5ft.	Moderately well drained	IIc	3405	85	60
G100A	Hamerly-Tonka complex, 0 to 3 percent slopes	66.02	41.3%		> 6.5ft.	Somewhat poorly drained	Ile	4114	61	51
G206A	Gwinner-Peever complex, 0 to 3 percent slopes	25.10	15.7%		> 6.5ft.	Moderately well drained	IIc	2875	88	52
G491A	Gardena-Glyndon loams, 0 to 2 percent slopes	1.50	0.9%		> 6.5ft.	Moderately well drained	Ile	3381	84	55
Weighted Average							2.00	3614.4	75.5	*n 55

*n: The aggregation method is "Weighted Average using all components"

*c: Using Capabilities Class Dominant Condition Aggregation Method