

# SERELLA STABLES

47.00 ACRES | PINELLAS COUNTY, FLORIDA



HAYDEN  
OUTDOORS  
REAL ESTATE



# SERELLA STABLES

OVERVIEW

LAND

IMPROVEMENTS

RECREATION

REGION  
& CLIMATE

LOCATION

MAPPING

Serella Stable



# OVERVIEW



## WELCOME TO SERELLA STABLES

### QUICK FACTS

- |             |              |
|-------------|--------------|
| 47.00 Acres | Recreational |
| Farm        | Residential  |
| Horse       | Timberland   |
| Hunting     | Vacant Land  |
| Plantation  | Waterfront   |
| Ranch       |              |

Tucked behind a private gated entrance just north of Tampa and Clearwater Beach, Serella Stables is a ±47-acre luxury equestrian estate blending Southern architecture and refined country living. Featuring a grand custom home, serene pond, and beautifully appointed stables, it offers exceptional privacy and prestige just minutes from the world-class beaches of Florida’s booming Gulf Coast.



# LAND



The contiguous acres of Serella Stables are perfectly arranged to balance usability and privacy.

The land is mostly level, with a mix of improved pasture and shaded pockets of woodland. Trails wind through the trees, providing access to the more remote parts of the property beyond the main cleared living area. The wooded sections attract abundant wildlife and offer peaceful opportunities to explore, observe nature, or enjoy the quiet beauty of the setting.

A fishing pond adds another layer of character to the estate, framed by mature trees and enhanced by a covered dock with a ceiling fan—a tranquil space for reflection or a quiet afternoon of fishing. Every part of the land feels intentional, designed to complement the home and equestrian facilities while preserving the natural beauty that defines the estate.





# IMPROVEMENTS



Beyond the gated stone entrance, a brick paver driveway connects the main residence, garage, guest house, barn, and arena in a graceful sweep through manicured lawns and open paddocks. Mature trees frame the landscape and create a natural privacy buffer, giving the entire property a sense of quiet seclusion.

The main residence at Serella Stables is a custom architectural statement—crafted with the timeless grace of a Southern estate and the substance of a modern luxury home. Spanning approximately 7,800 square feet, the home showcases a refined blend of natural materials and artisan detail. Wide-plank hardwood floors, reclaimed wood beams, custom cabinetry, and natural stone accents create a warm, sophisticated atmosphere throughout.

## FEATURES

- Homes: 1
- Style of Home(s): 2 Story
- Finished Sq. Ft.: 7,804
- Stories: 2
- Bedrooms: 4
- Full Bathrooms: 4
- Half Bathrooms: 1
- Parking Types: Detached Garage
- Outbuildings: 3
- Types of Outbuildings:
  - » Horse Barn
  - » Guest House includes shed
  - » Garage
- Cooling Systems: Forced Air Cooling
- Heating Systems: Fireplace & Forced Air
- Waterfront Features: Pond
- Appliances:
  - » Dishwasher
  - » Garbage Disposal
  - » Dryer, Refrigerator
  - » Hot Water Heater
  - » Microwave, Oven
  - » Stainless Stainless Steel
  - » Washer
- Flooring:
  - » Hardwood
  - » Marble
  - » Stone
  - » Tile
- Siding: Wood
- Roofing: Metal, Tile
  - » View:
  - » Pond
  - » Private
  - » Scenic
  - » Water
  - » Wooded







Walking into the grand two-story entry you'll find a circular staircase, a glass wall showcasing the wine cellar, and an impressive 1400 gallon saltwater aquarium, which is the anchoring centerpiece visible from multiple rooms. From the entry you will be awed by the Aspen-lodge-inspired main living area, which has beautifully crafted tongue-and-groove ceilings, exposed beams, industrial hardware detailing and stone architectural columns, all adding depth and character to this warm rustic ambiance. French doors lead into a private study with ample natural light and a steel safe. A vault-style door provides a dramatic entrance to the walk-down wine cellar with exposed brick and wood giving off Old World charm. The guest bath has a steampunk-inspired pedestal sink crafted from industrial copper piping and riveted hardware.



A chef's kitchen features professional-grade appliances, marble counters with custom wood cabinetry, multiple refrigerators and a charming farmhouse-inspired pantry with brick pavers and ample counter space for staging, prep and a coffee bar. The kitchen area seamlessly flows from a large indoor dining area to an outdoor kitchen and grilling area—perfect for entertaining. A curated lounge adds a unique space for entertaining; with its reclaimed wood accents, vintage inspired decor and custom lighting it is the perfect space for conversations, cocktails, and displaying prized possessions. The purpose-built family entrance from the detached garage has simple functionality for daily household organization in mind with wall cubby storage, a versatile central island, and walk-in closet.

Upstairs, the primary suite offers quiet luxury with dual walk-in closets and fine finishes, one of which is a boutique-style dressing room featuring frosted floor-to-ceiling built-ins with a dedicated vanity. This floor also provides three additional bedrooms, each with their own full bathroom, custom built-in closets, electronic curtains and french doors that lead out onto the wrap around porch. Each family member or guest can have their own private outdoor sitting area for enjoying the views overlooking the grounds.







Expansive porches and covered seating areas provide inviting spaces to take in the property's tranquil views. A swim-spa with bar-like seating on the outside, offers year-round enjoyment. The sellers can provide architectural plans for a pool and second outdoor kitchen, adding further dimension to the estate's outdoor living experience.

The center-aisle barn reflects the same craftsmanship as the home, featuring eight oversized, matted stalls, automatic waterers, spacious and well-appointed tack room with half bath, oversized wash bays, and ample storage. Chicago brick flooring, high ceilings, and generous airflow create an ideal environment for horses. Just beyond the barn lies an outdoor arena surrounded by multiple fenced paddocks for training and turnout.







A secondary garage and storage building includes an upper-level studio space currently used as a guest room, with completed plans available for conversion into a full guest cottage, photography shows a possible virtual representation. A detached multi-bay equipment building adds practical capacity for vehicles and maintenance while maintaining the estate's cohesive, polished aesthetic.

An impressive assemblage of celebrity and collector memorabilia is showcased throughout the residence, with select pieces negotiable as part of the sale or to convey based on offer. Certain furnishings and decor may also be available offering a turnkey option for buyers.



# RECREATION



Serella Stables offers a rare balance of privacy, recreation, and accessibility—where peaceful country living meets the refinement of Florida's Gulf Coast. The covered dock with ceiling fan provides a shaded retreat overlooking the stocked pond, perfect for unwinding or enjoying an afternoon of fishing in complete tranquility.

Endless miles of scenic horseback riding trails are located just moments away, making this an exceptional home base for horse owners of all kinds—a perfect retreat for your equine companions to rest and recover away from the racetrack or busy boarding stables.

Beyond its equestrian lifestyle, Serella Stables offers the freedom of hunting private land within a secure, gated setting. The property is set up for hunting deer, turkey, and hogs with established clearings, feeders, and stands already in place. The stocked pond provides year-round fishing, creating a complete outdoor experience without ever leaving home.

From early morning rides through shaded pastures to evenings on the porch or weekends along the Gulf, Serella Stables delivers a lifestyle that blends equestrian excellence, coastal living, and a recreational haven.





# REGION & CLIMATE



Florida continues to lead the nation in both population and economic growth, drawing new residents and investment from across the world. This is particularly true in the Tampa Bay region; a national study named Tampa the #2 mid-sized U.S. city for economic growth between 2019 and 2023, with St. Petersburg at #4 and Clearwater at #6 among small-sized cities.

The Tampa Bay region is renowned for its mild subtropical climate, where warm winters and gentle breezes make year-round outdoor living not only possible but truly enjoyable. For equestrian owners, this means extended riding seasons, lush pastures, and consistent conditions for training and care.

Located on Florida's Gulf Coast, Tarpon Springs embodies the character of Old-Florida charm within a community of established estates, waterfront homes, and preserved natural spaces. Its rich history, coastal influence, and convenient proximity to Tampa and Clearwater create a setting that is both relaxed and refined—offering access to city amenities while maintaining the peace and privacy of a rural retreat.

Tarpon Springs and the surrounding area offer an exceptional coastal experience. The historic downtown district offers boutique shopping, marinas, and waterfront dining. The white-sand beaches of Clearwater and Honeymoon Island are just minutes away, and Tampa's professional sports, fine arts, and culinary scenes are easily accessible.



# LOCATION



The estate's location places it within easy reach of Florida's equestrian and polo destinations. Riders and professionals alike appreciate the property's access to Tampa Bay Downs, Florida State Fairgrounds, the World Equestrian Center in Ocala, and Wellington's National Polo Center, all reachable within a day's drive or a short private flight. Whether training at home, competing on the winter circuit, or attending equestrian events, owners of Serella Stables are perfectly positioned within the state's premier network of horse communities.

Serella Stables is located at 3225 Keystone Road in Tarpon Springs, Florida, just north of Clearwater and Tampa. The property's placement is ideal—secluded behind its gated entry, yet connected to the region's finest equestrian, coastal, and cultural destinations.

- Tampa International Airport: ±22 miles (~30 minutes)
- Downtown Tampa: ±30 miles (~35 minutes)
- Clearwater Beach: ±21 miles (~35 minutes)
- Honeymoon Island State Park: ±14 miles (~25 minutes)
- Tampa Bay Downs: 8 miles (~20 min)
- World Equestrian Center (Ocala): ~100 miles (~2 hr)
- Wellington / National Polo Center: ~185 miles (~3.5 hr)

Within an hour of Serella Stables, owners can access Gulf beaches, championship golf, premier horse events, and international air travel—yet return home to the quiet elegance of a private gated estate.

This is a rare offering of privacy, room to roam, peaceful living, and adventure waiting at every turn- all wrapped up in effortless luxury.





# MAPPING

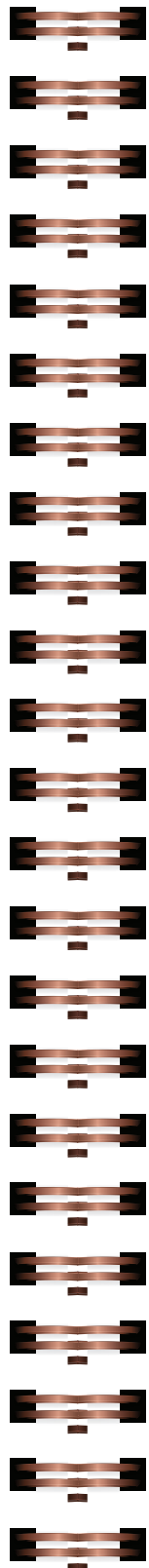
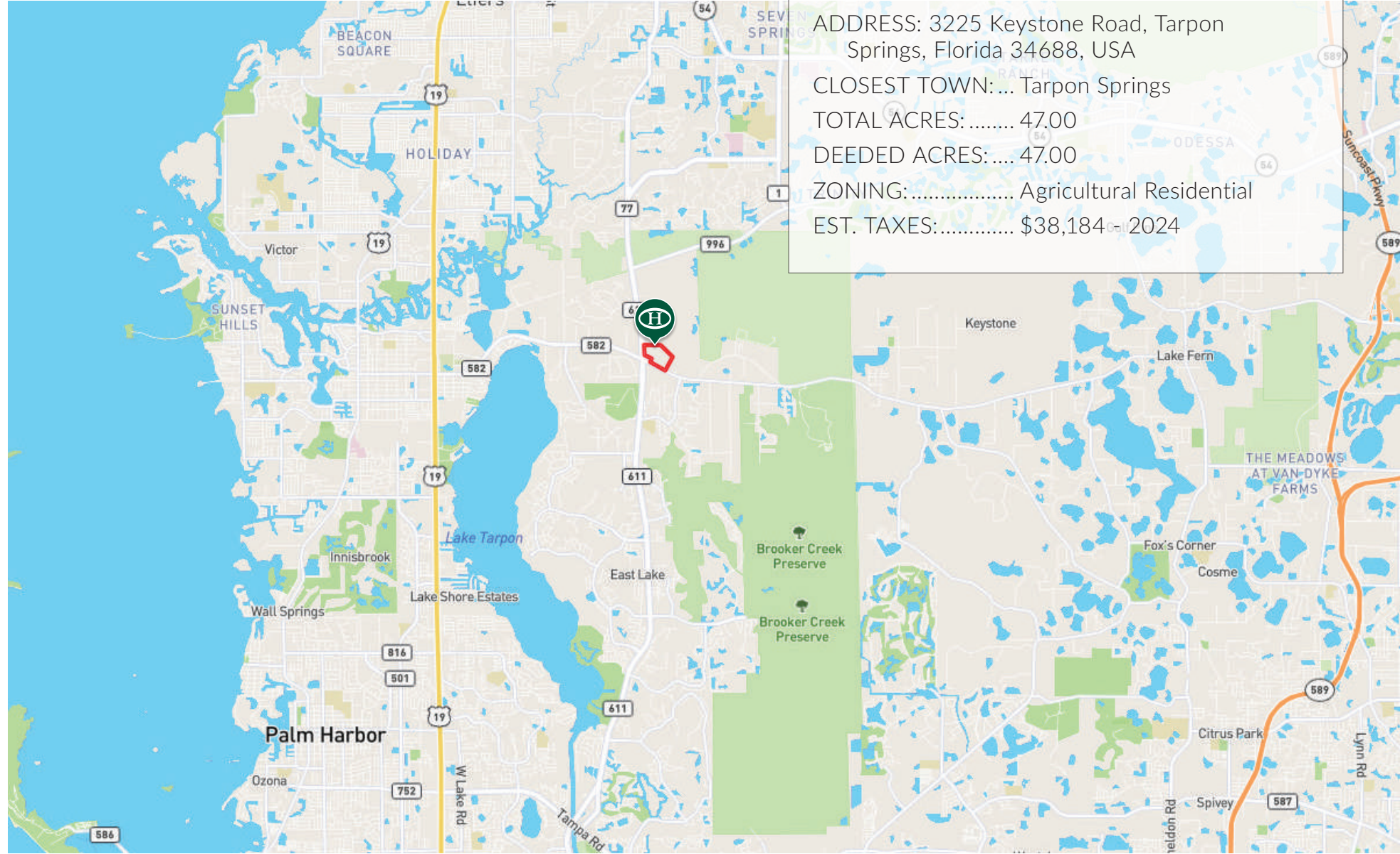





*Exclusively Presented By:*



**HAYDEN  
OUTDOORS**  
REAL ESTATE

**Lauren Fichtl**

Broker Associate, Licensed in NM, CO & FL  
850.797.5417 | [Lauren@HaydenOutdoors.com](mailto:Lauren@HaydenOutdoors.com)

**Chris Fichtl**

Sales Associate, Licensed in FL, NM & NE  
850.737.8248 | [ChrisF@HaydenOutdoors.com](mailto:ChrisF@HaydenOutdoors.com)

[www.HaydenOutdoors.com](http://www.HaydenOutdoors.com)