

CONSERVATION PLAN

UNITED STATES DEPARTMENT OF AGRICULTURE SOIL CONSERVATION SERVICE
cooperating with



Harvey County

Conservation District

Owner Gordon Bergkamp
Operator Gordon Bergkamp

Plan No. Mitigation
Scale 660"

Date 11-29-99
Acres _____
Approximate

Harvey Kansas NRCS
County State Assisted By

Photo No. _____

Location _____

N $\frac{1}{2}$ SW $\frac{1}{4}$ 18-23-2W
Tract 6783

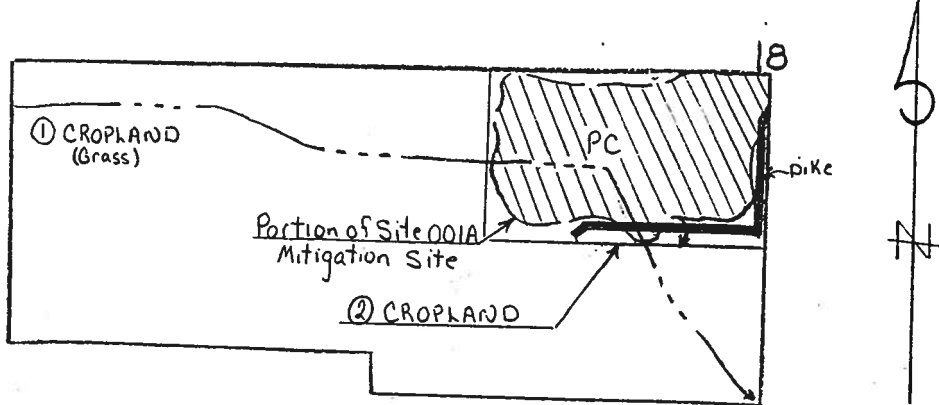

CONSERVATION PLAN
UNITED STATES DEPARTMENT OF AGRICULTURE SOIL CONSERVATION SERVICE
cooperating with
Harvey County
Conservation District



Owner Gordon Bergkamp Plan No. Mitigation Date 11-29-99
Operator Same Scale 660" Acres _____
Approximate Approximate
Harvey Kansas NRCS Photo No. _____
County State Assisted By
Location _____

SW 1/4 14-23-3W
Tract 30

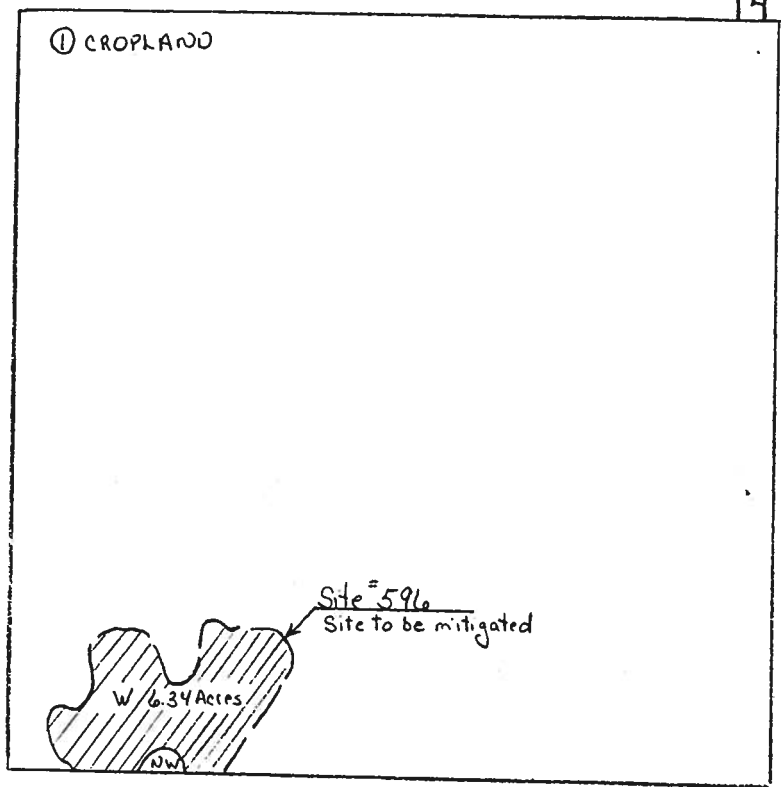

KANSAS

Owner: GORDON BERGKAMP
 Practice: WETLAND MITIGATION
 Location: Sec 18 Twp. 23 Rge. 2W
 County: HARVEY
 Longitude: Latitude:

Dillon - Co., Va. -
316-835-3495

INDEX TO DRAWINGS

Sheet	Description
2	Location Map
3	Plan View
4	Embankment Profile
5	Details & Cross Section
6	Seeding Details (KS-ECS-4)
7-8	Specifications

I certify that the plans and specifications for this project were developed by the Natural Resources Conservation Service and are approved.



 Signature

1/10/2000

 Date

BEFORE ANY INVESTIGATION OR CONSTRUCTION ACTIVITY THE EXCAVATOR IS RESPONSIBLE FOR CALLING KANSAS ONE-CALL AT (316)687-2470 (WICHITA AREA) OR 800-344-7233 (800-DIG-SAFE).

Date		Designed	
		Drawn	
		Checked	
		Approved	



File No.
Drawing No.
Sheet of

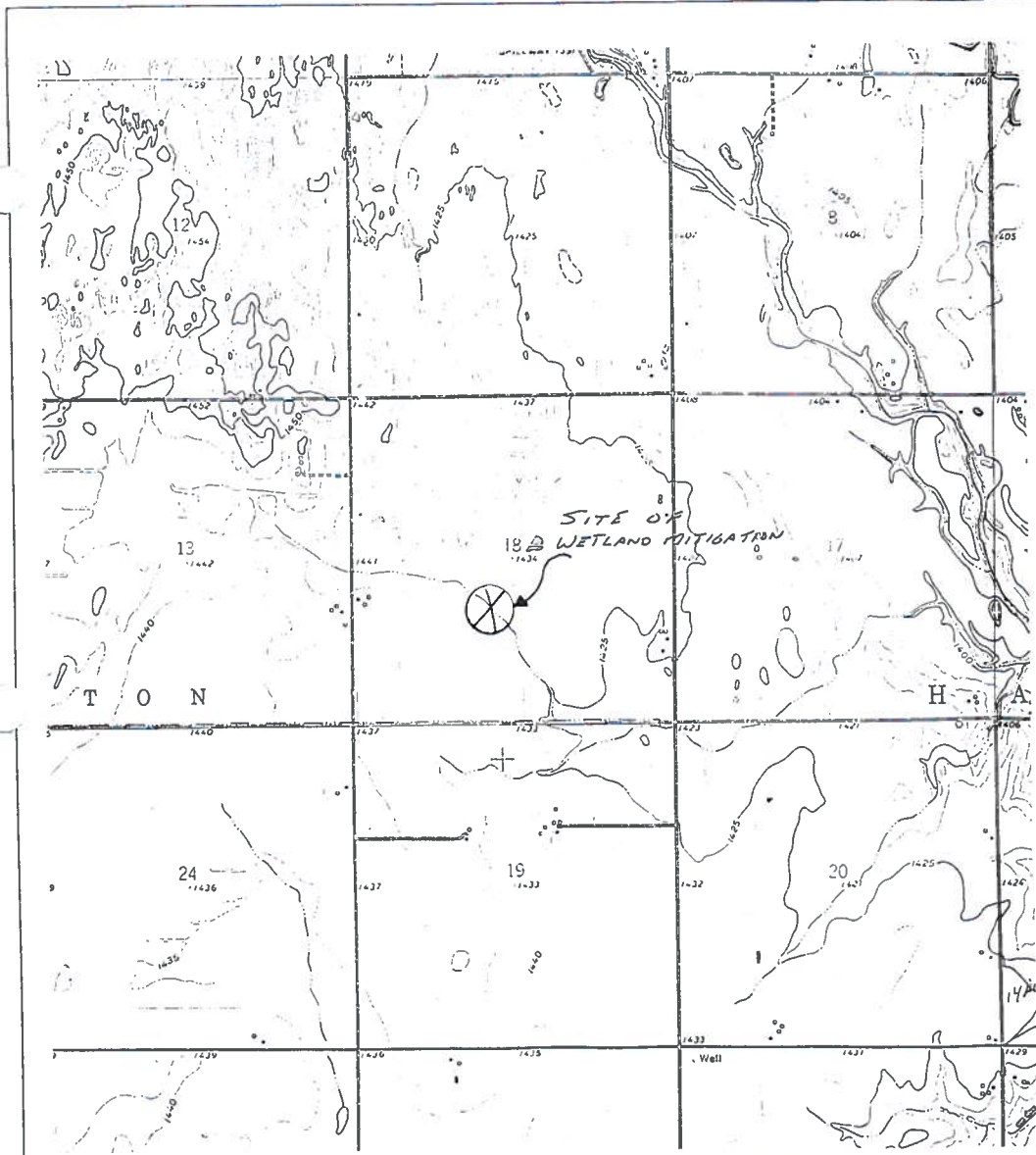

HALSTEAD QUADRANGLE

TABLE OF QUANTITIES

Item	Unit	Quantity
Wetland Development		
Fill - Embankment	cu. yds.	1,052
Core Trench	cu. yds.	403
Excavation		
Core Trench	cu. yds.	403
Pipe		
12" PVC, SDR 26 or Schedule 40	lin. ft.	48
12" Water Control Structure, 4' Tall	each	1
Grass Seeding	acres	7.84

Designed	1/00
Drawn	TLT
Checked	SSB
Approved	

Gordon Bergkamp
Wetland Mitigation Site
N2 SW4 18-23-2W
Harvey County, Kansas

USDA NRCS
Natural Resource Conservation Service

File No.
Drawing No.

LOCATION MAP and TABLE OF QUANTITIES



Edge of Field

NOTE:
The borrow area will be confined to the area below the 95.0 elevation. The finished bottom elevation of the borrow area will be no lower than elevation 93.5 and the bottom will be graded to facilitate draining of the site to the water control structure.



EMBANKMENT CENTER LINE
(Approximate location)

STA: 5+50 to 6+50
Emergency Spillway Location

STA. 3+15
Water Control Structure

BM1

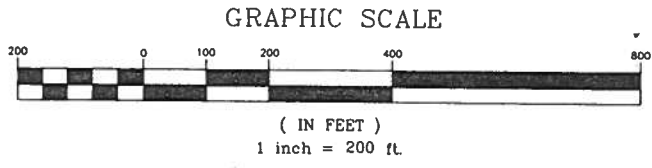

BM1 Elevation 100.0
Top of Wood Post, South of Trees

PLAN VIEW

Date	1/20/00
Designed	J.L.T.
Drawn	J.L.T.
Checked	SSB
Approved	J.L.T.

Gordon Bergkamp
Wetland Mitigation Site
N2 SW4 18-23-2W
Harvey County, Kansas



File No.	
Drawing No.	
Sheet	3 of 8

EMBANKMENT CROSS SECTION
(not to scale)

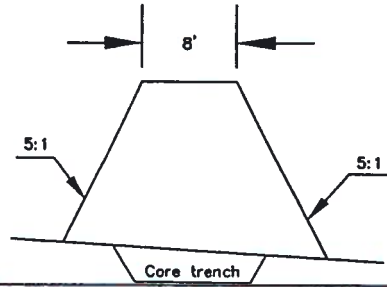

DATUM ELEV
90.00

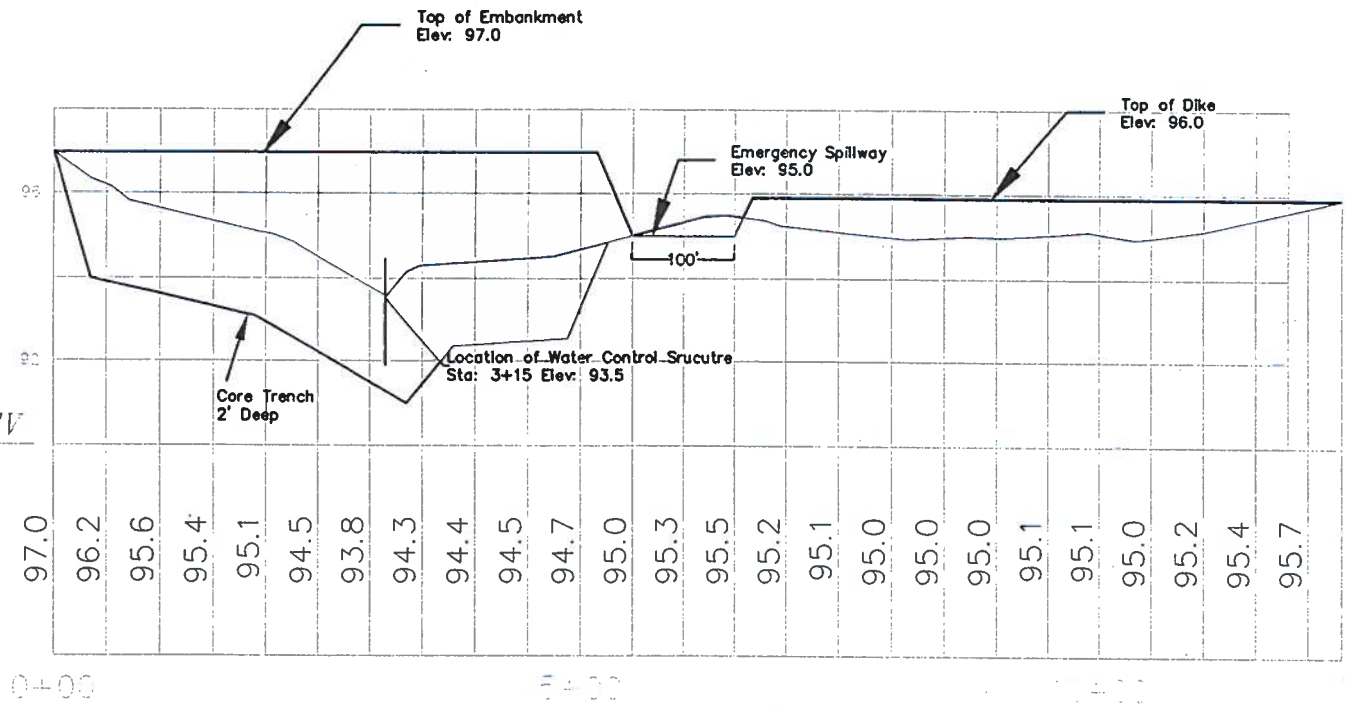

EMBANKMENT PROFILE

Date: 1/10
 Designed: JLT
 Drawn: JLT
 Checked: SSB
 Approved:

Gordon Bergkamp
 Wetland Mitigation Site
 N2 SW4 18-23-2W
 Harvey County, Kansas



File No.
 Drawing No.
 Sheet 4 of 8

EMERGENCY SPILLWAY PROFILE

(not to scale)

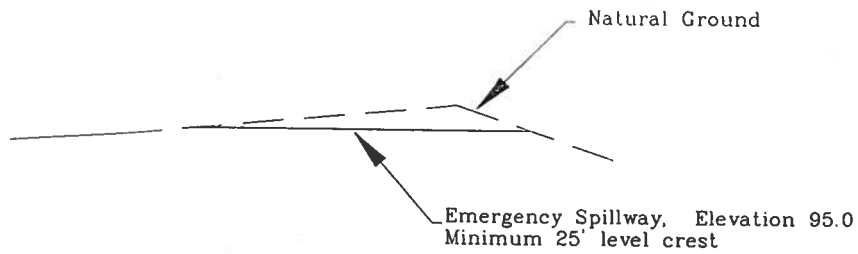

EMBANKMENT

(not to scale)

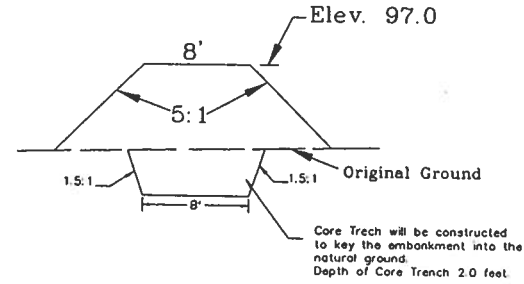

PROFILE OUTLET WORKS

(not to scale)

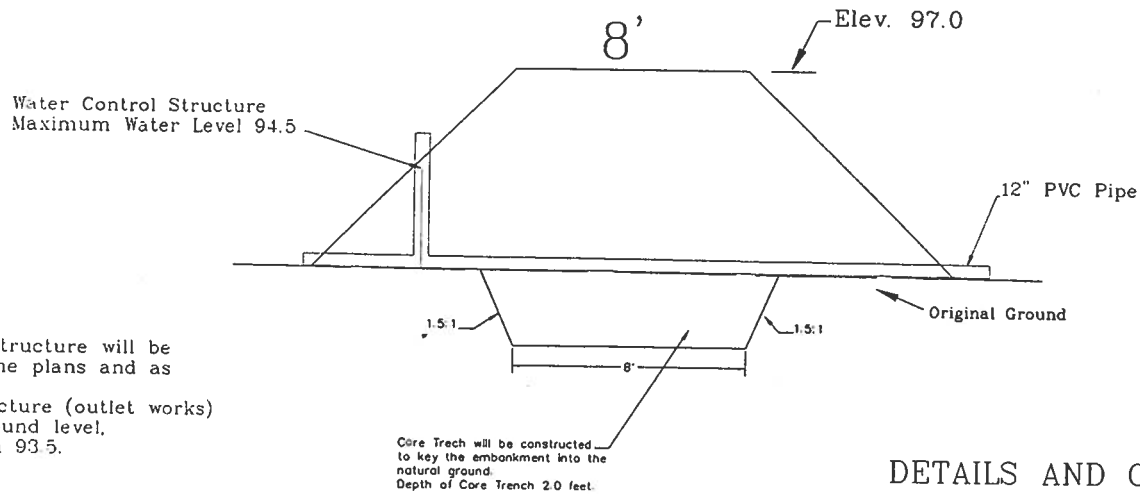

Note: Water Control Structure will be located as shown on the plans and as staked in the field. The water control structure (outlet works) will be installed at ground level, approximately elevation 93.5.

DETAILS AND CROSS SECTIONS

Date	1/20/02
Designed	Z.T.
Drawn	Z.T.
Checked	S.S.B.
Approved	

Gordon Bergkamp
Wetland Mitigation Site
N2 SW4 18-23-2W
Harvey County, Kansas



File No.	
Drawing No.	
Sheet of	

950 LF 18

Easement Area
Approx: 13.4 acres
850 LF x 615 LF

Ingress Egress Route

Bergkamp Mitigation Easement
NE 1/4 SW 1/4 16-23-210
(Approx: 13.4 acres)

The location easement area may be located using
the following UTM Readings (1983 NAD):

Northwest corner Northeast corner
Easting 624,030.44 Easting 624,247.70

Northing 4,212,187.92 Northing 4,212,193.44