

BOUNDARY SURVEY

SITUATED IN THE NORTH HALF OF THE SW¼ OF SECTION 28
TOWNSHIP 10 SOUTH, RANGE 96 WEST OF THE 6th PRINCIPAL MERIDIAN
COUNTY OF MESA, STATE OF COLORADO

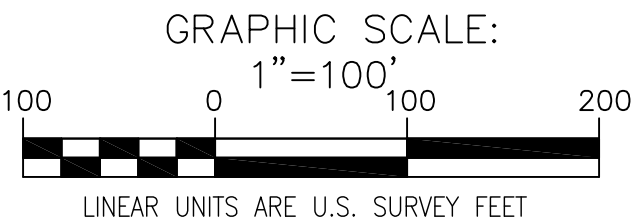
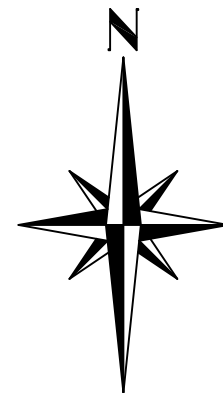

LEGEND:

FOUND SURVEY MARKER AS DESCRIBED
FOUND PROPERTY CORNER AS DESCRIBED
SET No. 5 REBAR WITH 2 INCH ALUMINUM CAP PLS 37904



LEGAL DESCRIPTION:

PARCEL #1
A parcel of land located in the SW¼ of section 28 Twp. 10S, Rge. 96W of 6th P.M. described as follows: Commencing at the W¼ corner of Sec. 28, Whence the Southwest corner of Sec. 28 bears South 00°33'29" West, thence South 89°47'52" East 1021.26 feet along the North line of the SW¼ of Sec. 28 to the True Point of Beginning, thence South 89°47'52" East 340.56 feet to the Northeast corner of the NW¼ SW¼ of Sec. 28, thence South 89°47'52" East 681.13 feet, thence South 00°57'19" West 875.27 feet, thence North 89°47'10" West 679.10 feet to the West line of the NE ½ SW¼ of Sec. 28, thence North 89°47'10" West 339.55 feet, thence North 00°45'25" East 875.03 feet to the True Point of Beginning.

PARCEL #3
E½ NE¼ SW¼ of Section 28, Township 10 South, Range 96 West of the 6th P.M.

AS RECORDED IN PLAT BOOK 2412 AT PAGE 409 OF THE MESA COUNTY CLERK AND RECORDER'S OFFICE
COUNTY OF MESA, STATE OF COLORADO

Said parcels contain 40.96 ACRES.

NOTES

- OWNERSHIP, RECORDED RIGHTS--OF--WAY, AND EASEMENT INFORMATION WAS DONE WITHOUT USING A CURRENT TITLE POLICY.
- BEARINGS ARE BASED ON THE EAST LINE OF THE NE¼ SW¼ SECTION 28, T10S, R96W OF THE 6TH P.M., FOUND IN PLACE WERE SURVEY MONUMENTS AT THE NORTH AND SOUTH ENDS OF SAID LINE AS SHOWN HEREON. THE VALUE USED S0°25'44"W IS BASED ON THE MESA COUNTY LOCAL COORDINATE SYSTEM.
- ACCORDING TO COLORADO LAW YOU MUST COMMENCE ANY LEGAL ACTION BASED UPON ANY DEFECT IN THIS SURVEY WITHIN THREE YEARS AFTER YOU FIRST DISCOVERED SUCH DEFECT. IN NO EVENT MAY ANY ACTION BASED UPON ANY DEFECT IN THIS SURVEY BE COMMENCED MORE THAN TEN YEARS FROM THE DATE OF THE CERTIFICATION SHOWN HEREON.
- THIS BOUNDARY SURVEY IS BASED ON THE DEED AS RECORDED AT RECEPTION NUMBER 1835244, OF THE MESA COUNTY RECORDS.

SURVEYOR'S CERTIFICATION:

I, Patrick W. Click, a registered Professional Land Surveyor in the State of Colorado, do hereby certify that this Plat represents a field survey completed by me and / or under my direct supervision. Both conform to the standards of practice, statutes and laws of the State of Colorado to the best of my knowledge and belief. This statement is not a guaranty or warranty, either expressed or implied.

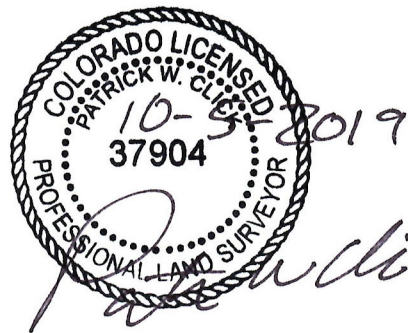

COLORADO REGISTERED LAND SURVEYOR PLS #37904

BOUNDARY SURVEY		
HILLTOP HEALTH SERVICES		
SITUATED IN THE NORTH HALF OF THE SW¼ SECTION 28		
TOWNSHIP 10 SOUTH, RANGE 96 WEST OF THE 6TH PRINCIPAL MERIDIAN		
COUNTY OF MESA, STATE OF COLORADO		
DATE: 10/5/19	JOB #: 2019076	FIELD WORK: KM AND JW
DRAWING NAME: 50158 EAGLES WAY	DRAWN BY: PC	
POLARIS SURVEYING		
PATRICK W. CLICK P.L.S.		
3194 MESA AVE. #B		
GRAND JUNCTION, CO 81504		
PHONE/FAX (970)434-7038		

