



Thomas J. Wellard, PLS
Rodney Clark, PE

November 13, 2023

Legal Description for
Rob and Melba Wiggins
Job No. OC0123

Parcel 2

This parcel is a portion of the N $\frac{1}{2}$ NW $\frac{1}{4}$ NW $\frac{1}{4}$ SE $\frac{1}{4}$ and the NE $\frac{1}{4}$ SW $\frac{1}{4}$ of Section 8 in Township 13 North, Range 3 West of the Boise Meridian, Washington County, Idaho and is more particularly described as follows:

BEGINNING at the Northwest corner of the N $\frac{1}{2}$ NW $\frac{1}{4}$ NW $\frac{1}{4}$ SE $\frac{1}{4}$, (C $\frac{1}{4}$ Corner, Section 8), a found 5/8 inch diameter rebar;

thence South 89°31'50" East along the North boundary of the N $\frac{1}{2}$ NW $\frac{1}{4}$ NW $\frac{1}{4}$ SE $\frac{1}{4}$ a distance of 242.06 feet to a $\frac{1}{2}$ x 24 inch rebar set with a plastic cap stamped P.L.S. 15352;

thence South 00°05'58" West, parallel with the East boundary of the N $\frac{1}{2}$ NW $\frac{1}{4}$ NW $\frac{1}{4}$ SE $\frac{1}{4}$, a distance of 330.53 feet to a point on the South boundary of the N $\frac{1}{2}$ NW $\frac{1}{4}$ NW $\frac{1}{4}$ SE $\frac{1}{4}$, a $\frac{1}{2}$ x 24 inch rebar set with a plastic cap stamped P.L.S. 15352;

thence North 89°32'34" West along said South boundary a distance of 241.15 feet to the Southwest corner of the N $\frac{1}{2}$ NW $\frac{1}{4}$ NW $\frac{1}{4}$ SE $\frac{1}{4}$, a found 5/8 inch diameter rebar;

thence North 00°03'33" West along the West boundary of the N $\frac{1}{2}$ NW $\frac{1}{4}$ NW $\frac{1}{4}$ SE $\frac{1}{4}$ a distance of 172.53 feet to a $\frac{1}{2}$ x 24 inch rebar set with a plastic cap stamped P.L.S. 15352;

thence South 89°52'41" West a distance of 17.38 feet to a point witnessed by a $\frac{1}{2}$ x 24 inch rebar set with a plastic cap stamped P.L.S. 15352 bearing North 00°34'23" West a distance of 10.00 feet;

thence North 00°34'23" West a distance of 158.18 feet to a point on the North boundary of the NE $\frac{1}{4}$ SW $\frac{1}{4}$, a $\frac{1}{2}$ x 24 inch rebar set with a plastic cap stamped P.L.S. 15352;

thence South 89°45'22" East along said North boundary a distance of 18.80 feet to the **POINT OF BEGINNING**, said parcel being 1.899 acres more or less, and being subject to any and all easements and rights of way of record or implied.

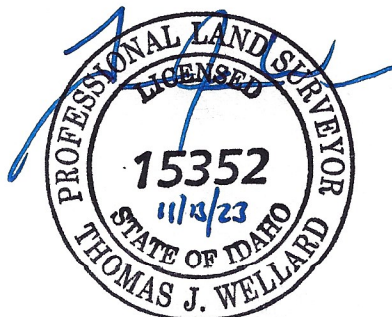

November 13, 2023

Legal Description for
Rob and Melba Wiggins
Job No. OC0123

Parcel 3

This parcel is a portion of the NE ¼ SW ¼ of Section 8 in Township 13 North, Range 3 West of the Boise Meridian, Washington County, Idaho and is more particularly described as follows:

COMMENCING at the Northeast corner of the NE ¼ SW ¼, (C ¼ Corner, Section 8), a found 5/8 inch diameter rebar;

thence North 89°45'22" West along the North boundary of the NE ¼ SW ¼ a distance of 18.80 feet to the **TRUE POINT OF BEGINNING**, a ½ x 24 inch rebar set with a plastic cap stamped P.L.S. 15352;

thence South 00°34'23" East a distance of 158.18 feet to a point witnessed by a ½ x 24 inch rebar set with a plastic cap stamped P.L.S. 15352 bearing North 00°34'23" West a distance of 10.00 feet;

thence North 89°52'41" East a distance of 17.38 feet to a point on the East boundary of the NE ¼ SW ¼, a ½ x 24 inch rebar set with a plastic cap stamped P.L.S. 15352;

thence South 00°03'33" East along said East boundary a distance of 190.55 feet to a point on the centerline of a drain ditch witnessed by a found 5/8 inch diameter rebar bearing North 00°03'33" West a distance of 18.01 feet;

thence North 89°28'46" West along said centerline a distance of 428.52 feet to a ½ x 24 inch rebar set with a plastic cap stamped P.L.S. 15352;

thence South 16°45'15" West a distance of 77.17 feet to a point witnessed by a ½ x 24 inch rebar set with a plastic cap stamped P.L.S. 15352 bearing South 88°07'48" West a distance of 11.50 feet;

thence South 88°07'48" West a distance of 184.61 feet to a ½ x 24 inch rebar set with a plastic cap stamped P.L.S. 15352;

thence North 00°37'00" West a distance of 427.37 feet to a point on the North boundary of the NE ¼ SW ¼, a ½ x 24 inch rebar set with a plastic cap stamped P.L.S. 15352;

thence South 89°45'22" East along said North boundary a distance of 620.71 feet to the **TRUE POINT OF BEGINNING**, said parcel being 5.366 acres more or less, and being subject to any and all easements and rights of way of record or implied.

