

**CHAPDELAINÉ
& ASSOCIATES
LAND SURVEYING**

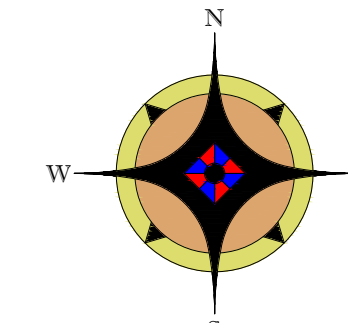

7376 WALKER ROAD,
FAIRVIEW, TENNESSEE 37062
(615) 799-8104
chapsurveyors@msn.com
Randolph L. Chapdelaine
TN R.L.S. #1444

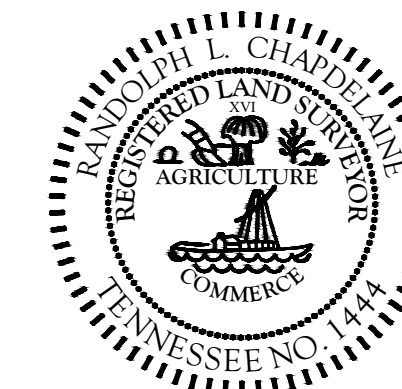
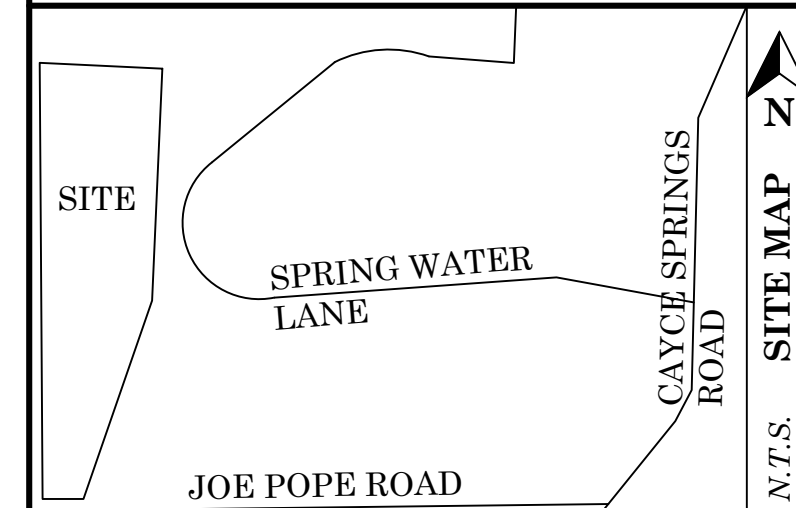

CERTIFICATE OF ACCURACY

I HEREBY CERTIFY THAT THIS IS A CATEGORY IV SURVEY AND THAT THIS MAP WAS DRAWN UNDER MY SUPERVISION. THIS SURVEY WAS DONE IN COMPLIANCE WITH CURRENT TENNESSEE MINIMUM STANDARDS OF PRACTICE, AND THE FOLLOWING INFORMATION WAS USED TO PERFORM THE SURVEY:

- REAL TIME KINEMATIC & BASE SOKKIA GRX 3
- POSITIONAL ACCURACY: 0.05 FEET
- DATE OF SURVEY: 8/4/2022
- DATUM / EPOCH: NAD83 (2011) EPOCH
- PUBLISHED / FIXED CONTROL: TDOT CORS NETWORK
- GEOID MODEL: GEOID 12B
- COMBINED GRID FACTOR: 0.99991394

RANDOLPH L. CHAPDELAINÉ, R.L.S. # 1444 DATE

OWNERS:
WAYNE McCULLOUGH, GARY LEN POPE,
GERARD LESLIE POPE,
GREGORY LEWIS POPE,
GERALD LANCE POPE,
GWENDOLYN POPE BANKS
1724 JOE POPE ROAD
DEED BOOK 1346 PAGE 943 R.O.W.C.
4th CIVIL DISTRICT OF
WILLIAMSON COUNTY, TENNESSEE
PROPERTY MAP 147 PARCEL 37

REVISION # DATE

DATE: AUGUST 04, 2022

DRAWN BY: NAB

JOB #: 7087

SCALE: 1" = 100'

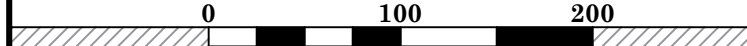

V-1.1

BOUNDARY SURVEY FOR WAYNE McCULLOUGH ET AL PROPERTY

INHERENT RESOLVE, LLC "SERIES 5"
JOE POPE ROAD
DEED BOOK 803 PAGE 296 R.O.W.C.
PROPERTY MAP 147 PARCEL 16.03

JAMES F MOORE
THERESA D MOORE
1761 SPRING WATER LANE
DEED BOOK 4592 PAGE 72 R.O.W.C.
PLAT BOOK 38 PAGE 32 R.O.W.C.
PROPERTY MAP 147 PARCEL 18.05

JAMES F MOORE
1761 SPRING WATER LANE
DEED BOOK 2200 PAGE 55 R.O.W.C.
PROPERTY MAP 147 PARCEL 18.06

BRANDON HERRENBRUCK
MIRANDI HERRENBRUCK
1722 JOE POPE ROAD
DEED BOOK 8979 PAGE 33 R.O.W.C.
PLAT BOOK 47 PAGE 91 R.O.W.C.
PROPERTY MAP 147 PARCEL 37.06

HENRY PARKS POPE
BARBARA E. POPE
JOE POPE ROAD
DEED BOOK 5548 PAGE 845 R.O.W.C.
PROPERTY MAP 147 PARCEL 16

ANNA L. SHAFFER
1804 POPES CHAPEL ROAD
DEED BOOK 1346 PAGE 38 R.O.W.C.
PROPERTY MAP 147 PARCEL 50

ANNA L. SHAFFER
EVERGREEN ROAD
DEED BOOK 2647 PAGE 507 R.O.W.C.
PROPERTY MAP 147 PARCEL 49.01

12.89 Acres
561,514 Sq. Feet

LEGEND

- UNDERGROUND ELECTRIC LINE
- OVERHEAD ELECTRIC LINE
- TELECOMMUNICATION LINE
- WIRE FENCE
- WOOD FENCE
- CHAIN LINK FENCE
- WATER LINE
- SEWER LINE
- FORCE MAIN SEWER
- GAS LINE
- SILT FENCE
- WELL
- UTILITY POLE
- GRID STAKE
- EXISTING IRON PIN (UNLESS NOTED)
- EXISTING CONCRETE MONUMENT
- IRON PIN SET (UNLESS NOTED)
- POINT
- FIRE HYDRANT
- ELECTRIC METER
- WATER METER
- GAS METER
- SEWER MANHOLE
- STORM MANHOLE
- WATER VALVE
- ELECTRIC TRANSFORMER BOX
- ELECTRIC PULL BOX

GENERAL NOTES

- THE PURPOSE OF THIS MAP IS TO PROVIDE A VISUAL DEPICTION OF THE PROPERTY LINES FOR A 12.89 ACRE TRACT.
- THE SUBJECT PROPERTY LIES IN A ZONE "X" (AREA OF MINIMAL FLOOD HAZARD) AS SHOWN ON FIRM MAP #14700010P DATED 8/29/2006.
- ALL DISTANCES SHOWN HEREON ARE BASED UPON A FIELD-RUN SURVEY USING GPS EQUIPMENT TIED TO TDOT CORS.
- UTILITIES, IF SHOWN, WERE TAKEN FROM VISIBLE STRUCTURES AT THE SITE. VERIFICATION OF THEIR EXISTENCE, LOCATION, SIZE, AND DEPTH, SHOULD BE MADE BEFORE MAKING DECISIONS REGARDING THEM. AVAILABILITY OF SERVICES SHOULD BE CONFIRMED WITH THE APPROPRIATE LOCAL UTILITY COMPANY. TENNESSEE ONE CALL (811) SHOULD BE CALLED BEFORE ANY CONSTRUCTION OR DIGGING.
- THIS SURVEY WAS MADE WITHOUT THE BENEFIT OF A TITLE REPORT. IT IS THEREFORE SUBJECT TO THE FINDINGS OF AN ACCURATE TITLE REPORT.
- THIS PROPERTY IS SUBJECT TO BOTH RECORDED EASEMENTS, AND TO THOSE UNKNOWN TO THIS SURVEYOR.
- PROBABLE WETLAND AREAS, AS IDENTIFIED EITHER BY THE NATIONAL WETLANDS INVENTORY OR FOUND AT THE TIME OF THE SURVEY, ARE SHOWN ON THIS PLAN. VERIFICATION AND DELINEATION OF THE PERIMETER LOCATION OF THESE OR ANY OTHER SUCH AREAS WHICH MAY EXIST ON THE PROPERTY SHOULD BE MADE BY THE OWNER OR DEVELOPER THROUGH THE RELEVANT GOVERNMENT AGENCY AND A WETLAND DELINEATION CONSULTANT PRIOR TO IMPROVEMENT, DESIGN, OR DEVELOPMENT OF THE PROPERTY. AT LEAST SIX GOVERNMENT AGENCIES HAVE REGULATION AUTHORITY OVER THE USE OR ALTERATION OF WETLAND AREAS AND INCLUDE THE FOLLOWING: U.S. ARMY CORPS OF ENGINEERS; U.S. ENVIRONMENTAL PROTECTION AGENCY; U.S. FISH AND WILDLIFE SERVICE; TENNESSEE WILDLIFE RESOURCES AGENCY; TENNESSEE DIVISION OF WATER POLLUTION CONTROL; TENNESSEE NATURAL RESOURCES CONSERVATION SERVICE.
- TOPOGRAPHY DATUM BASED ON NAVD 1988 TAKEN FROM TENNESSEE LIDAR MAPPING AND FIELD CHECKED.

